



Structural Damage Assessment via Model Updating Using Augmented Grey Wolf Optimization Algorithm

S. Ghasemi^{*a}, G. Ghodrati Amiri^b, M. Mohamadi Dehcheshmeh^a

^a Civil Engineering Department, Shahrekord Branch, Islamic Azad University, Shahrekord, Iran

^b Centre of Excellence for Fundamental Studies in Structural Engineering, School of Civil Engineering, Iran University of Science & Technology, Tehran, Iran

PAPER INFO

Paper history:

Received 31 October 2019
Received in revised form 05 April 2020
Accepted 11 June 2020

Keywords:

Augmented Grey Wolf Optimization Algorithm
Damage Detection
Flexibility Matrix
Modal Data
Static Strain Energy

ABSTRACT

Some civil engineering-based infrastructures are planned for the structural health monitoring (SHM) system based on their importance. Identification and detecting damage automatically at the right time are one of the major objectives this system faces. One of the methods to meet this objective is model updating with use of optimization algorithms in structures. This paper is aimed to evaluate the location and severity of the damage combining two being-updated parameters of the flexibility matrix and the static strain energy of the structure using augmented grey wolf optimization (AGWO) and only with extracting the data of damaged structure, by applying 5 percent noise. The error between simulated and estimated results in average of ten runs and each damage scenario was less than 3 percent which proves the proper performance of this method in detection of the all damages of the 37-member three-dimensional frame and the 33-member two-dimensional truss. Moreover, they indicate that AGWO can provide a reliable tool to accurately identify the damage in compare with the particle swarm optimizer (PSO) and grey wolf optimizer (GWO).

doi: 10.5829/ije.2020.33.07a.02

1. INTRODUCTION

After long term utilization, the infrastructures should be evaluated in terms of safety and sustainability. Over time, a structure may lose its desired performance due to the factors such as earthquakes, floods, storms, etc. This may even leads to its collapse.

With the advent of advanced technologies including sensor networks, information and signal processing and managing systems [1–3], The SHM process has been able to enhance safety, sustainability, the development of infrastructure, measuring and management of cost of exploitation over time. The use of monitoring provides with the required information in building smart structures; such as, equipment needed to measure or record data before the structure gets damaged more.

The Prognosis of damage by using traditional methods of local inspection or testing due to an increase in the number and dimensions of structures and their deterioration is not feasible because inspection of such

structures is time consuming, costly and along with human error. Therefore, to control the remaining useful life of large and more complex structures, new methods based on changes in the vibration properties of structures have been developed; that are commonly referred to as damage detection methods [4]. The basic idea is that the modal data of the structure, such as frequency and mode shapes are influenced by the physical properties of the structure, so changes in the physical properties of the structure lead to change in its modal properties. Consequently, by comparing the modal characteristics of the structure before and after the damage, the location and severity of damage to the structure can be detected [5].

First time Holland [6] investigated the problem of detecting damage based on natural frequency with genetic algorithm. One method that has attracted many researchers today is the numerical update model method. Detection of damage without the need for undamaged structural data is one of the advantages of this method.

*Corresponding Author Email: ghasemi@std.iaushk.ac.ir (S. Ghasemi)

Defining the objective function and determining the being-updated parameters are among the most important factors affecting the success of these method. In updating the numerical model using the inverse problem, the difference between the simulated and estimated results is minimized with the help of the optimizer algorithm.

A comprehensive review by Friswell and Mottershead [7] has been conducted on various methods of updating the model. Hajela and Soeiro [8] examined two optimization methods on a 15-member -dimensional truss, and obtained acceptable results. Boulkaibet et al. [9], used the Monte Carlo combining simulation, were able to provide a more precise method and introduce probabilities in a model update process for more sophisticated systems. Other researchers utilizing the sensitivity of the frequency response functions detected the severity of the damage [10, 11]. Ghodrati et al. [12, 13] used the flexibility matrix parameters and the modal residual force and came up with strong and stable results.

Flexibility matrix and static strain energy are two being-updated parameters used in this method which are introduced in this paper.

Yan and Golinval [14] also use covariance-based subspace detection techniques to identify modal parameters. The stiffness matrix variations to detect damage is used as it is significantly altered due to major damage to the structure, but if the damage is small, this method is not very effective. Dynamic data and flexibility can be elicited out of dynamic experiments and structure frequency response measurements, respectively. One of the methods to detect vibration-based damage is to use statistical analysis [15, 16]. Tomaszewska [17] investigated the influence of statistical errors on damage detection methods and concentrated on the flexibility and mode shape curvature approaches as methodologies that use both natural frequencies and mode shapes. Damage detection from mode shape data requires measurements in many locations of a structure. Therefore, damage detection methods based on flexibility were utilized by researchers [18–20]. Li et al. [21] presented a generalized -flexibility matrix for a definite reduction of natural frequencies of higher modes. The flexibility matrix by applying a unit force to values of degrees of freedom (DOFs) can be used as a modal displacement to calculate the strain variation of members. Accordingly, an efficient method was used to detect multiple damage to the truss system using strain-based flexibility index (SCBFI) [22] and another flexibility-based damage probability index (FBDPI) [23], simulation results showed high performance. Zare Hosseinzadeh et al. [24] employed an effective method based on the calculation of static displacement by a matrix of flexibility. The efficiency of the proposed method was verified by an experimental study of a five-story structure with shear frame. Kaveh and Zolghadr [25] used the object function of flexibility

matrix and modal strain energy (MSE) method as a conducting tool in order to detect a beam and portal frame's damage detection process.

Shi et al. [26] proposed a damage detection-method using differences in the MSE for the simple two-story plain structure. The results were partially successful in quantification of the structural damage in spite of errors. Modal-strain-energy-based methods have generally shown promise for locating damage [27–31]. However, while it has numerous advantages over other methods; recent research has shown that its application to three-dimensional frame-type structures is limited [32]. Seyedpoor and Yazdanpanah [33] found in a study on a static strain energy-based damage index (SSEBI) that this method is more reliable under similar conditions than modal strain energy-based damage index (MSEBI). Cha and Buyukozturk [34] discovered a new method for detecting damage in three-dimensional steel structures using the hybrid multiobjective genetic. Their method well detects the small damages when there is no noise. Li et al. [35] developed an Improved Modal Strain Energy (IMSE) method for detecting damage in offshore platform structures and compared it with Stubbs index method. Their comparative studies showed that the IMSE index outperformed the Stubbs index and exhibited stronger robustness.

In this paper, detection of damage considered in five sections of the introduction, overview of the AGWO, structural damage detection approach based on taking advantage of the mentioned being-updated parameters with the strategy of choosing the best performance, numerical examples. Finally, the summary is outlined in conclusions. Figure 1 illustrates the flowchart of research methodology of present work.

2. AUGMENTED GREY WOLF OPTIMIZER

Algorithm AGWO modifies the global algorithm's grey wolf optimization (GWO) by focusing on search parameter (A). This algorithm simulates the group behaviour of gray wolves in hunting, who have a leader called α . And secondary wolves with the name β , which help α in decision making (See Figure 2). Here α means estimated results to solve the problem in the research.

The hunting process is divided into four below categories.

2. 1. Searching for Prey The exploration of the prey location can be achieved by the divergence of search agents, which can be achieved when $|A| > 1$, the main parameter responsible for exploration and exploitation is parameter A which mainly depends on parameter a as given in Equation (1).

$$\vec{a} = 2 - \cos(rand) \times t/Max_iter \quad (1)$$

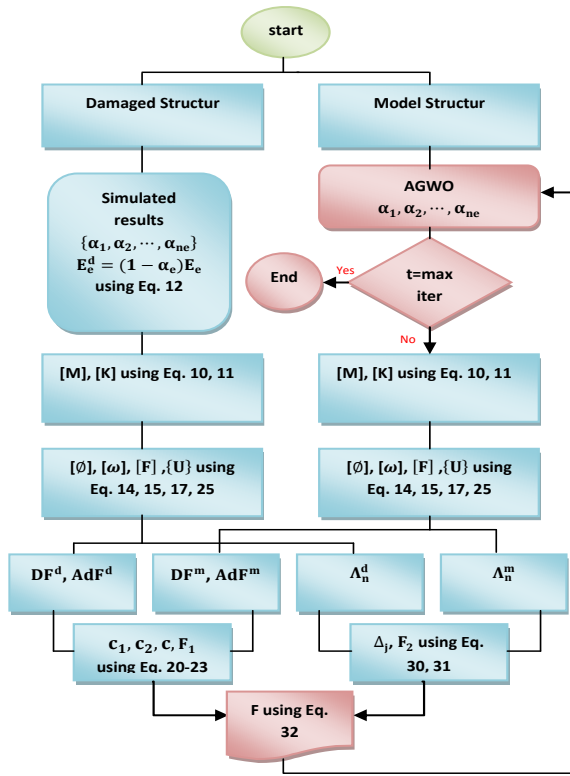

Figure 1. Flowchart of research methodology



Figure 2. Hunting process [36]

$$\vec{A} = 2 - \vec{a} \cdot \vec{r}_1 - \vec{a} \tag{2}$$

$$\vec{C} = 2 \cdot \vec{r}_2 \tag{3}$$

where r_1 and r_2 are uniformly distributed random vectors between 0 and 1 and parameter changes nonlinearly and randomly from 2 to 1 with iteration (t) increased until it reaches maximum iteration.

2. 2. Encircling the Prey The mathematical model of encircling the prey is expressed as follows:

$$\vec{D} = |\vec{C} \cdot \vec{X}_{pi} - \vec{X}_i| \tag{4}$$

$$\vec{X}_{i+1} = \vec{X}_{pi} - \vec{A} \cdot \vec{D} \tag{5}$$

where \vec{X} is the position vector of grey wolf, \vec{X}_p is the position vector of the prey.

2. 3. Hunting In the proposed AGWO algorithm, the hunting will depend only on α and β as given in Equations (6)-(8).

$$\vec{D}_\alpha = |\vec{C}_1 \cdot \vec{X}_{\alpha i} - \vec{X}_i|, \vec{D}_\beta = |\vec{C}_2 \cdot \vec{X}_{\beta i} - \vec{X}_i| \tag{6}$$

$$\vec{X}_1 = \vec{X}_{\alpha i} - \vec{A}_1 \cdot \vec{D}_\alpha, \vec{X}_2 = \vec{X}_{\beta i} - \vec{A}_2 \cdot \vec{D}_\beta \tag{7}$$

$$\vec{X}_{1+i} = \vec{X}_1 + \vec{X}_2 / 2 \tag{8}$$

2. 4. Attacking the Prey The exploitation of (attacking) the prey can be achieved by the convergence of search agents, which is investigated when $|A| < 1$ [37].

3. PROPOSED METHOD

The free vibration equation of a structural in an undamped state is written as follows:

$$[M]\{\ddot{X}\} + [K]\{X\} = 0 \tag{9}$$

where $[M]$ and $[K]$ are the matrices of the mass and stiffness of the structure, respectively. These matrices can be obtained from the direct stiffness method for the number of elements (ne). Also $\{\ddot{X}\}$, $\{X\}$, $[M^e]$ and $[K^e]$ are acceleration, displacement vectors, the matrices of the mass and stiffness of each element, respectively.

$$[M] = \sum_{e=1}^{ne} [M^e] \tag{10}$$

$$[k] = \sum_{e=1}^{ne} [k^e] \tag{11}$$

Damage to the structure reduces the stiffness of the damaged element, which is a function of the modulus of elasticity. Thus, by reducing the modulus of elasticity of the elements using Equation (12), the actual damage to the structure is simulated.

$$E_e^d = (1 - \alpha_e)E_e \tag{12}$$

where E_e^d the modulus of elasticity of the damaged element, α_e the amount of damage to the element (a number between zero and one), where the zero indicates that there is no damage, the one indicates a damage of

100% of the element, and E_e is the modulus of elasticity of the element in the undamaged state.

Modal parameters are obtained by the solution to this equation:

$$[K - \omega_i^2 M][\phi_i] = 0, i = 1, 2, \dots, n \quad (13)$$

According to the Equation (13), the mode shapes and the square of the natural frequencies of the structure can be obtained for n of DOFs, respectively:

$$[\omega] = \begin{bmatrix} \omega_{11}^2 & \dots & 0 \\ \vdots & \ddots & \vdots \\ 0 & \dots & \omega_{nn}^2 \end{bmatrix} \quad (14)$$

$$[\phi] = \begin{bmatrix} \phi_{11} & \dots & \phi_{1n} \\ \vdots & \ddots & \vdots \\ \phi_{n1} & \dots & \phi_{nn} \end{bmatrix} \quad (15)$$

In case of noise, its effect in this section is applied to the damaged structure using the following equation:

$$[\omega_p] = [\omega] \times (1 + N \times rand) \quad (16)$$

where ω_p is the output, N represents the noise level which is 5% in this paper, and the *rand* vector [-1,1] is the random variable distributed by the software.

Thus, by using Equations (14) and (15) the flexibility matrix can be written as follows:

$$[F]_{n \times n} = [\phi]_{n \times nm} [\omega]_{nm \times nm}^{-1} [\phi]_{n \times nm}^T \quad (17)$$

in which, nm is the number of the modes used. Now, the diagonal and anti-diagonal elements of the Equation (17) are used, respectively:

$$DF = \{F_{1,1}, F_{2,2}, \dots, F_{n,n}\}^T \quad (18)$$

$$AdF = \{F_{1,n}, F_{2,n-1}, \dots, F_{n,1}\}^T \quad (19)$$

Based on Equations (18) and (19), four vectors are defined in order to determine C . DF^d and AdF^d are the two vectors defined for the damaged structure, and DF^m and AdF^m are those of the model structure.

$$c_1 = \frac{|DF^{dT} \cdot DF^m|^2}{(DF^{dT} \cdot DF^d)(DF^{mT} \cdot DF^m)} \quad (20)$$

$$c_2 = \frac{|AdF^{dT} \cdot AdF^m|^2}{(AdF^{dT} \cdot AdF^d)(AdF^{mT} \cdot AdF^m)} \quad (21)$$

$$C = (c_1 \times c_2)^2 \quad (22)$$

Then, F_1 is obtained:

$$F_1 = \left(\cos^{-1}(C) \times \frac{180}{\pi} \right)^{1/2} \quad (23)$$

The static strain energy of the structure can be simulated by applying the following equation for the nm mode used:

$$[K] \times \{U\} - \{P\} = 0 \quad (24)$$

"If a static force, like the vector $\{P\}$, is applied to the free DOFs of the structure, the static displacements of these DOFs can be calculated by" [24]:

$$\{U\} = [K]^{-1} \times \{P\} = [F]_{n \times n} \times \{P\}_{n \times 1} \quad (25)$$

where $[K]^{-1}$ is the flexibility matrix, $\{U\}$ the vector of static nodal displacement and $\{P\}$ "A unique static load is as follows applied to the structure with n DOFs" [24]:

$$\{P\} = [1 \ 1 \ 1 \ \dots \ 1]^T \quad (26)$$

Then, using the Equation (25), the static strain energy of each element can be calculated as follows [33]:

$$\Lambda_e = \frac{1}{2} (u_e^T \times K^e \times u_e), e = 1, 2, \dots, ne \quad (27)$$

where u_e is the vector of static nodal displacement of each element, and Λ_e is the static strain energy of e -th element. For the function convergence, the static strain energy of the structure (Λ) gets normalized:

$$\Lambda_{norm} = \sqrt{\sum_{e=1}^{ne} (\Lambda_e)^2} \quad (28)$$

$$\Lambda_{n,e} = \Lambda_e / \Lambda_{norm}, e = 1, 2, \dots, ne \quad (29)$$

where Λ_{norm} is the static strain energy norm of the structure, and $\Lambda_{n,e}$ is the unit static strain energy of e -th element. Thus, by defining two vectors of Λ_n^d and Λ_n^m for the damaged and model structures, F_2 is obtained as follows:

$$\Delta_j = |\log(\Lambda_n^d)_j - \log(\Lambda_n^m)_j|, j = 1, 2, \dots, ne \quad (30)$$

$$F_2 = (\max(\Delta_1, \Delta_2, \dots, \Delta_{ne}))^2 \quad (31)$$

Therefore, the objective function is defined as follows:

$$f(\alpha_1, \alpha_2, \dots, \alpha_{ne}) = \min(F_1, F_2) \quad (32)$$

4. ANALYSIS AND RESULT

In this section the applicability of the presented method is demonstrated by studying two-dimensional truss and three-dimensional frame structures under different damage patterns. Moreover, applying the minimum modes number, noise and various scenarios, the efficiency of the object function and accuracy algorithm AGWO in comparison with to GWO and PSO are examined. It should be declared that all analyses have been made in the workspace of MATLAB software.

4. 1. Two-Dimensional Truss

The finite element model of this structure consists of 33 elements as illustrated in Figure 3. Damage scenarios are given in Table 1, and its material properties are as follows: modules of elasticity $E = 2 \times 10^6$ kg/cm², mass density

$\rho = 7.85 \text{ gr/cm}^3$ and area $A = 36.2\text{cm}^2$, respectively. Also, parameters of optimization algorithm as follows: maximum number of iterations=1000, number of population of wolves=100, upper bound=1, lower bound=0.

The results of damage detection of the two-dimensional truss data with 0% noise, and 5% noise for the first, second and third scenarios are presented in Figures 4, 5 and 6, respectively.

Convergence curves for the AGWO in the third damage scenario of the two-dimensional truss data with: 0% noise and 5% noise are illustrated in Figure 7.

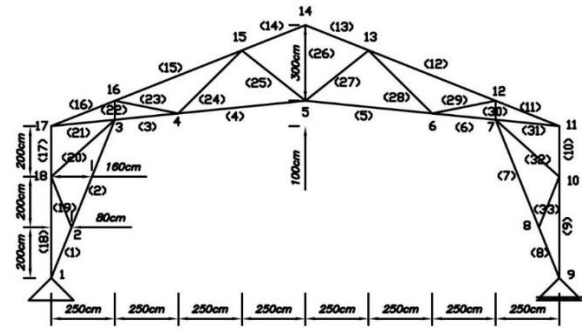

Figure 3. Two-dimensional truss

TABLE 1. Different damage scenarios for the two-dimensional truss

Damage scenario 1		Damage scenario 2		Damage scenario 3	
Element number	Damage (%)	Element number	Damage (%)	Element number	Damage (%)
2	10	9	5	1	20
		27	15	26	10
				33	25

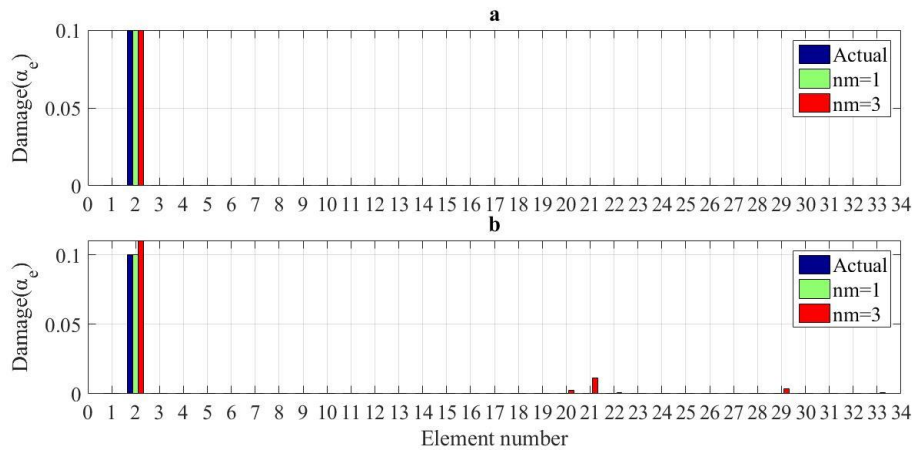

Figure 4. The results of damage detection in the first scenario of the two-dimensional truss data with: (a) 0% noise, (b) 5% noise

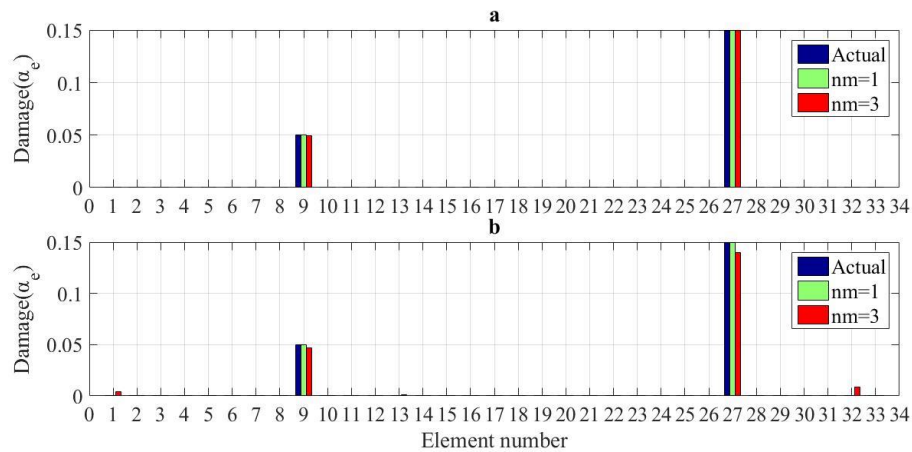

Figure 5. The results of damage detection in the second scenario of the two-dimensional truss data with: (a) 0% noise, (b) 5% noise

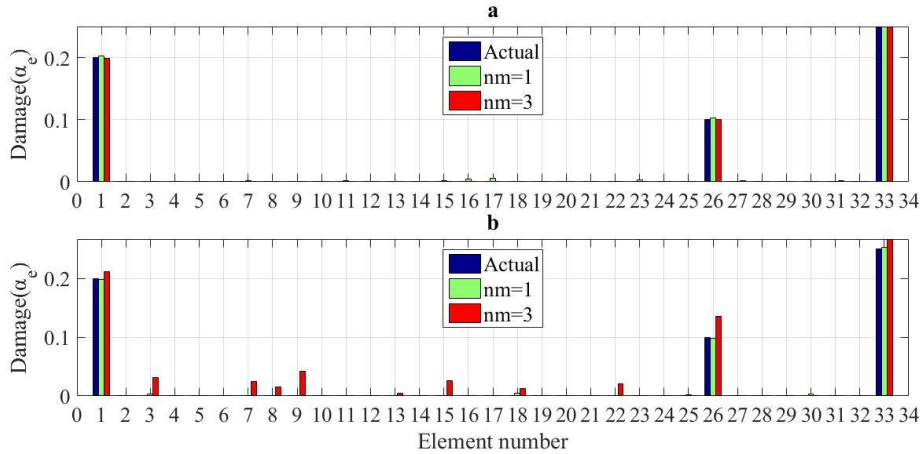

Figure 6. The results of damage detection in the third scenario of the two-dimensional truss data with: (a) 0% noise, (b) 5% noise

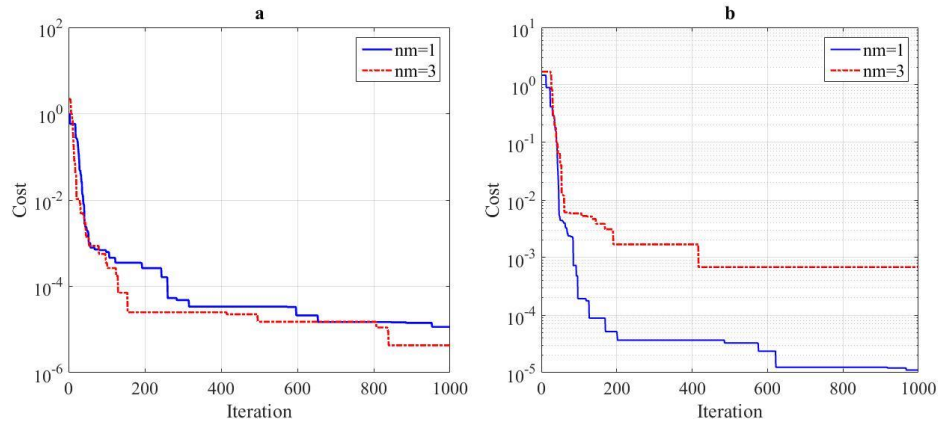

Figure 7. Convergence curves for the AGWO in the third damage scenario of the two-dimensional truss data with: (a) 0% noise, (b) 5% noise

4. 2. Three-Dimensional Frame

The three dimensional frame model of this structure consists of 37 elements and 28 nodes which have six DOFs each as illustrated in Figure 8. Damaged scenarios are given in Table 2. For this structure, modules of elasticity are $E = 2 \times 10^6 \text{ kg/cm}^2$, mass density, $\rho = 7.85 \text{ g/cm}^3$, moment of horizontal inertia $I_h = 4162 \text{ cm}^4$, moment of vertical inertia $I_v = 4162 \text{ cm}^4$, shear modulus $G = 793000 \text{ kg/cm}^2$, torsional constant $J = 2081 \text{ cm}^4$, area $A = 64 \text{ cm}^2$, the horizontal length $L_H = 500 \text{ cm}$, the vertical length $L_V = 320 \text{ cm}$. Also, parameters of optimization algorithm as follows: maximum number of iterations=1000, number of population of wolves=200, upper bound=1, lower bound=0.

The results of damage detection of the three-dimensional frame and the first seven modes for the first, second and third scenarios are presented in Figures 9, 10 and 11, respectively. Because of the random nature of the heuristic optimization algorithms, the average results of 10 damage detection independent runs of studied

optimization algorithms investigated and shown in Figure 12.

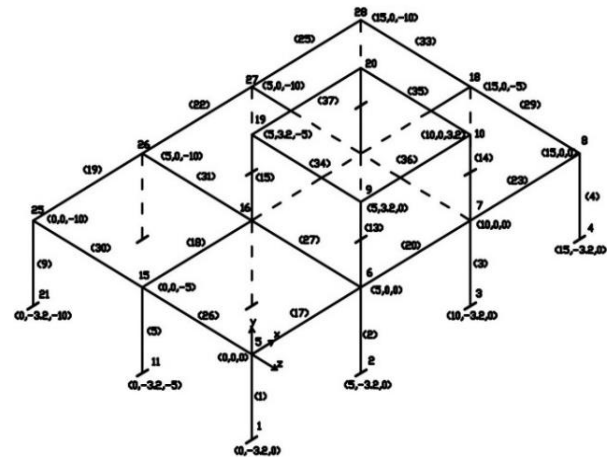

Figure 8. Three-dimensional frame

TABLE 2. Different damage scenarios for the three-dimensional frame

Damage scenario 1		Damage scenario 2		Damage scenario 3	
Element number	Damage (%)	Element number	Damage (%)	Element number	Damage (%)
10	10	7	5	1	10
		24	15	15	20
				35	25

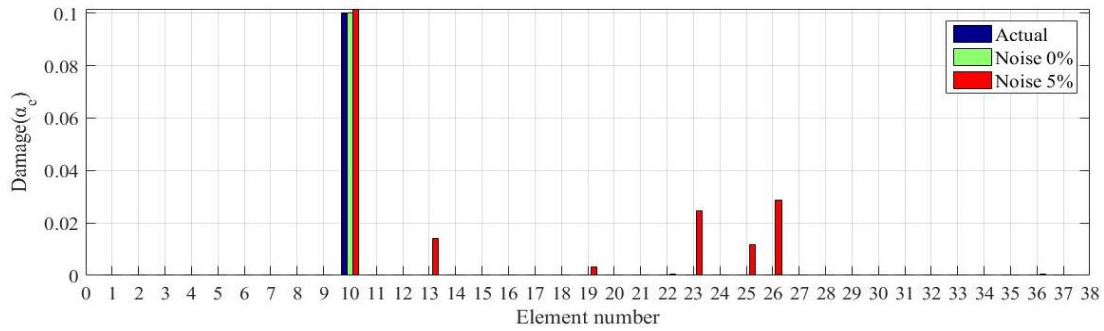

Figure 9. The results of damage detection in the first scenario of the three-dimensional frame for the first seven modes

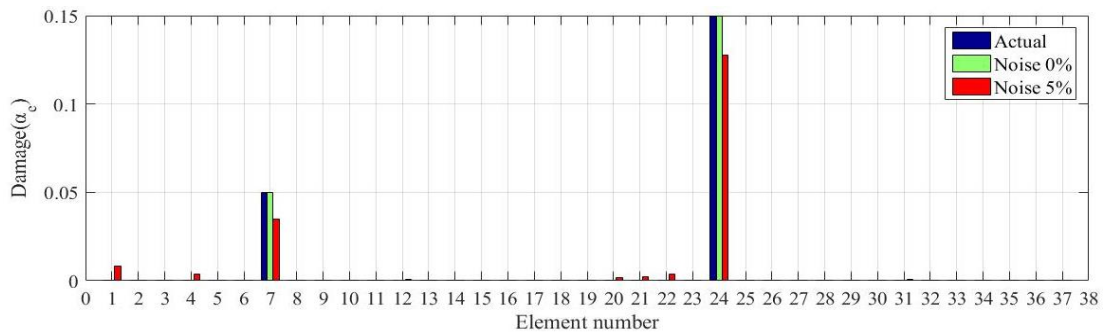

Figure 10. The results of damage detection in the second scenario of the three-dimensional frame for the first seven modes

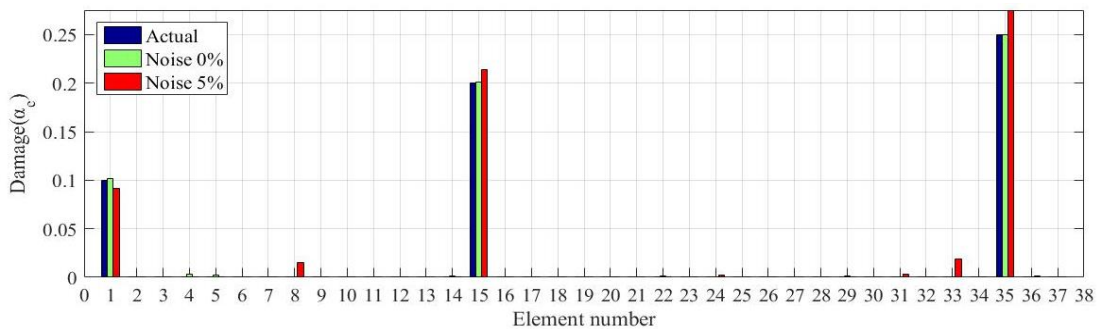

Figure 11. The results of damage detection in the third scenario of the three-dimensional frame for the first seven modes

To compare the reliability and efficiency of optimization algorithms, the best, worst and, the standard deviation (SD) of the results among the 10 independent runs are presented in Table 3. As shown in Figure 13

from the left to right, the convergence curves for the third damage scenario of the three-dimensional frame data with 0% noise and 5% noise are illustrated for the AGWO, GWO and PSO, respectively.

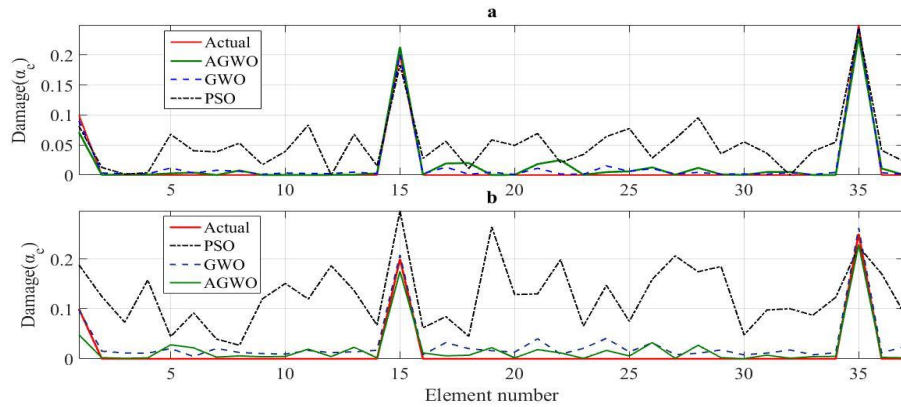

Figure 12. The average results damage detection of ten independent runs for the PSO, GWO and AGWO in the third damage scenario of the three-dimensional frame data with: (a) 0% noise, (b) 5% noise

TABLE 3. The best, worst, average and the standard deviation of the results among at ten independent runs for the optimization algorithms in the third damage scenario of the three-dimensional frame

Algorithm	AGWO (f_{min})		GWO (f_{min})		PSO (f_{min})	
	0 (%)	5(%)	0(%)	5(%)	0(%)	5(%)
Run Number 1	0.00000	0.00066	0.00000	0.00015	0	0.00610
Run Number 2	0.00000	0.00017	0.00031	0.00016	0.000109	0.00432
Run Number 3	0.00000	0.00076	0.00000	0.00011	0.001945	0.00772
Run Number 4	0.00000	0.00009	0.00000	0.00013	0.002431	0.00593
Run Number 5	0.00568	0.00276	0.00000	0.00031	0	0.00028
Run Number 6	0.00067	0.00021	0.00000	0.00025	0.004679	0.00311
Run Number 7	0.00000	0.00062	0.00000	0.00016	0.004165	0.00210
Run Number 8	0.00000	0.00064	0.00000	0.00008	0	0.00476
Run Number 9	0.00000	0.00323	0.00000	0.00026	0.000639	0.00217
Run Number 10	0.00058	0.00010	0.00000	0.00027	0	0.00054
Maximum	0.00568	0.00323	0.00031	0.00031	0.00468	0.00772
Minimum	0.00000	0.00009	0.00000	0.00008	0	0.00028
Average	0.00069	0.00092	0.00003	0.00019	0.00140	0.00370
Sd	0.00177	0.00113	0.00010	0.00008	0.00182	0.00248

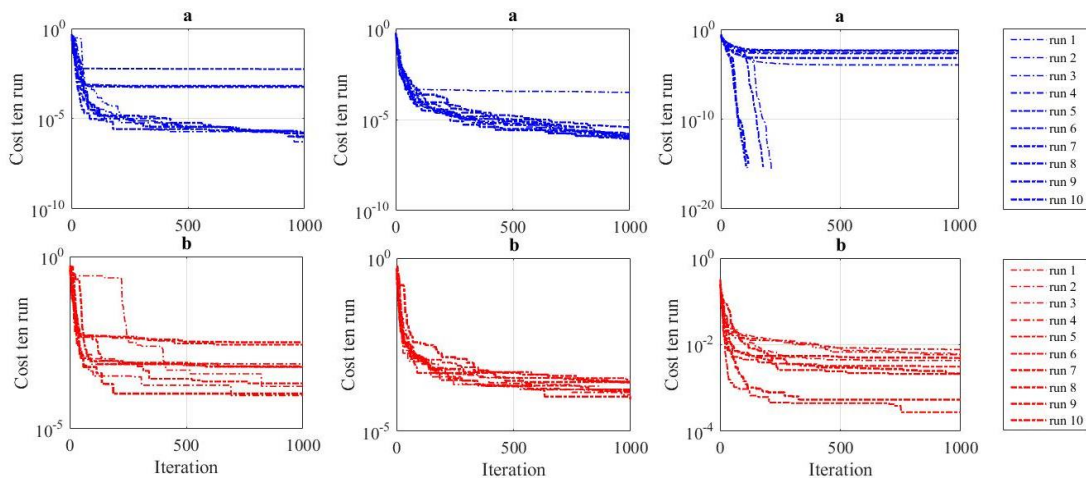

Figure 13. Convergence curves shown left to right respectively for the AGWO, GWO and PSO in the third damage scenario of the three-dimensional frame data with: (a) 0% noise, (b) 5% noise

5. CONCLUSION

In this study, an updating-based-model strategy is presented in which by combining two being-updated parameters of the flexibility matrix and the static strain energy of the structure along with the use of optimization, structural damage assessment is achieved.

Despite the limitation in process of damage assessment in two-dimensional and three-dimensional structures with high DOFs along with applying multiple damages in different parts of the structure, using noise. It is assumed that by using structural static strain energy advantages to improve the performance of the proposed objective function and reduce the weakness of small and general damage detection in flexibility-matrix-based methods and using the first few modes of the structure, damages are evaluated very precisely.

Moreover, by comparing different studies in section 4 including average results of the 10 runs, statistical results and convergence with other evolutionary optimization algorithms of PSO and GWO, the stability of the AGWO algorithm is evaluated.

The error between simulated and estimated results in average of ten runs and each damage scenario was less than 3 percent which proves the proper performance of this method in detecting the damage of the 37-member frame and the 33-member truss. Investigation on the experimental model, combining other being-updated parameters and using other new heuristic and multi objective algorithms in the method is recommended.

6. ACKNOWLEDGEMENTS

Hereby, we thank several people who helped us to complete this article: Farzaneh Haratyan, Masoud Shahi Juneghani and Marzieh Keshavarzi.

7. REFERENCES

- Hamidian, D., Salajegheh, J., Salajegheh, E., "Damage Detection of Irregular Plates and Regular Dams by Wavelet Transform Combined Adoptive Neuro Fuzzy Inference System," *Civil Engineering Journal*, Vol. 4-2 (2018), 305-319. doi: 10.28991/cej-030993
- Saljoughi, A.S., Mehrvarz, M., and Mirvaziri, H., "Attacks and intrusion detection in cloud computing using neural networks and particle swarm optimization algorithms," *Emerging Science Journal*, Vol. 1, No. 4, (2017), 179-191. doi: 10.28991/ijse-01120
- Kouhdaragh, M., "Experimental Investigation of Damage Detection in Beam Using Dynamic Excitation System", *Civil Engineering Journal*, Vol. 3, No. 10 (2017), 920-928. doi: 10.28991/cej-030925
- El-Wazery, M.S., Hassan, A., and Hassan, S., "Health Monitoring of Welded Steel Pipes by Vibration Analysis", *International Journal of Engineering, Transactions C: Aspects*, Vol. 28, No. 12, (2015), 1782-1789. doi: 10.5829/idosi.ije.2015.28.12c.11
- Khoshnoudian, F., and Esfandiari, A., "Structural damage diagnosis using modal data", *Scientia Iranica*, Vol. 18, No. 4, (2011), 853-860. doi: 10.1016/j.scient.2011.07.012
- Holland, J. H., "Adaptation in natural and artificial systems", University of Michigan Press, (1975).
- Friswell, M., and Mottershead, J.E., Finite element model updating in structural dynamics (Vol. 38). Springer Science & Business Media, (2013).
- Hajela, P., and Soeiro, F.J., "Recent developments in damage detection based on system identification methods", *Structural Optimization*, Vol. 2, No. 1, (1990), 1-10. doi: 10.1007/BF01743515
- Boulkaibet, I., Mthembu, L., Marwala, T., Friswell, M. I., and Adhikari, S., "Finite element model updating using the shadow hybrid Monte Carlo technique", *Mechanical Systems and Signal Processing*, Vol. 52, (2015), 115-132. doi: org/10.1016/j.ymssp.2014.06.005
- Esfandiari, A., Bakhtiari-Nejad, F., Rahai, A., and Sanayei, M., "Structural model updating using frequency response function and quasi-linear sensitivity equation", *Journal of Sound and Vibration*, Vol. 326, No. 3-5, (2009), 557-573. doi: 10.1016/j.jsv.2009.07.001
- Shadan, F., Khoshnoudian, F., and Esfandiari, A., "A frequency response-based structural damage identification using model updating method", *Structural Control and Health Monitoring*, Vol. 23, No. 2, (2016), 286-302. doi: 10.1002/stc.1768
- Ghodrati Amiri, G., Zare Hosseinzadeh, A., and Seyed Razzaghi, S. A., "Generalized flexibility-based model updating approach via democratic particle swarm optimization algorithm for structural damage prognosis", *Iran University of Science & Technology*, Vol. 5, No. 4, (2015), 445-464. doi: ijoce.iust.ac.ir/article-1-227-en.html
- Ghodrati Amiri, G., Jafarian Abyaneh, M., and Zare Hosseinzadeh, A., "Model Updating-Based Approach for Damage Prognosis in Frames via Modal Residual Force", *International Journal of Civil and Environmental Engineering*, Vol. 10, No. 8, (2016), 1005-1011. doi: 10.5281/zenodo.1125801
- Yan, A., and Golinval, J.C., "Structural damage localization by combining flexibility and stiffness methods", *Engineering Structures*, Vol. 27, No. 12, (2005), 1752-1761. doi: 10.1016/j.engstruct.2005.04.017
- Catbas, F.N., Brown, D.L., and Aktan, A.E., "Use of modal flexibility for damage detection and condition assessment: case studies and demonstrations on large structures", *Journal of Structural Engineering*, Vol. 132, No. 11, (2006), 1699-1712. doi: 10.1061/(ASCE)0733-9445(2006)132:11(1699)
- Sung, S.H., Koo, K.Y., and Jung, H.J., "Modal flexibility-based damage detection of cantilever beam-type structures using baseline modification", *Journal of Sound and Vibration*, Vol. 333, No. 18, (2014), 4123-4138. doi: 10.1016/j.jsv.2014.04.056
- Tomaszewska, A., "Influence of statistical errors on damage detection based on structural flexibility and mode shape curvature", *Computers & Structures*, Vol. 88, No. 3-4, (2010), 154-164. doi: 10.1016/j.compstruc.2009.08.017
- Miguel, L.F.F., Miguel, L.F.F., Riera, J.D., and Menezes, R.C.R.D., "Damage detection in truss structures using a flexibility based approach with noise influence consideration", *Structural Engineering and Mechanics*, Vol. 27, No. 5, (2007), 625-638. doi: 10.12989/sem.2007.27.5.625
- Yan, Y. J., Cheng, L., Wu, Z. Y., and Yam, L. H., "Development in vibration-based structural damage detection technique." *Mechanical Systems and Signal Processing*, Vol. 21, No. 5 (2007), 2198-2211. doi: 10.1016/j.ymssp.2006.10.002
- Nobahari, M., and Seyedpoor, S.M., "An efficient method for structural damage localization based on the concepts of flexibility matrix and strain energy of a structure", *Structural Engineering and Mechanics*, Vol. 46, No. 2, (2013), 231-244. doi:

- 10.12989/sem.2013.46.2.231
21. Li, J., Wu, B., Zeng, Q.C. and Lim, C.W., "A generalized flexibility matrix based approach for structural damage detection", *Journal of Sound and Vibration*, Vol. 329, No. 22, (2010), 4583-4587. doi: 10.1016/j.jsv.2010.05.024
 22. Montazer, M., and Seyedpoor, S.M., "A new flexibility based damage index for damage detection of truss structures", *Shock and Vibration*, 2014, (2014). doi: 10.1155/2014/460692
 23. Seyedpoor, S.M., and Montazer, M. "A damage identification method for truss structures using a flexibility-based damage probability index and differential evolution algorithm", *Inverse Problems in Science and Engineering*, Vol. 24, No. 8, (2016), 1303-1322. doi: 10.1080/17415977.2015.1101761
 24. Zare Hosseinzadeh, A., Ghodrati Amiri, G., and Koo, K.Y., "Optimization-based method for structural damage localization and quantification by means of static displacements computed by flexibility matrix", *Engineering Optimization*, Vol. 48, No. 4, (2016), 543-561. doi: 10.1080/0305215X.2015.1017476
 25. Kaveh, A., and Zolghadr, A., "Guided modal strain energy-based approach for structural damage identification using tug-of-war optimization algorithm", *Journal of Computing in Civil Engineering*, Vol. 31, No. 4, (2017), 04017016. doi: 10.1061/(ASCE)CP.1943-5487.0000665
 26. Shi, Z.Y., Law, S.S., and Zhang, L.M., "Structural damage detection from modal strain energy change", *Journal of Engineering Mechanics*, Vol. 126, No. 12, (2000), 1216-1223. doi: 10.1061/(ASCE)0733-9399(2000)126:12(1216)
 27. Wang, S., Zhang, J., Liu, J. and Liu, F., "Comparative study of modal strain energy based damage localization methods for three-dimensional structure", In the 20th International Offshore and Polar Engineering Conference, 20-25 June, Beijing, China, (2010).
 28. Seyedpoor, S.M., "A two stage method for structural damage detection using a modal strain energy based index and particle swarm optimization", *International Journal of Non-Linear Mechanics*, Vol. 47, No. 1, (2012), 1-8. doi: 10.1016/j.ijnonlinmec.2011.07.011
 29. Yan, W.J., Huang, T.L. and Ren, W.X., "Damage detection method based on element modal strain energy sensitivity", *Advances in Structural Engineering*, Vol. 13, No. 6, (2010), 1075-1088. doi: 10.1260/1369-4332.13.6.1075
 30. Yan, W.J., Ren, W.X. and Huang, T.L., "Statistic structural damage detection based on the closed- form of element modal strain energy sensitivity", *Mechanical Systems and Signal Processing*, Vol. 28, (2012), 183-194. doi: 10.1016/j.ymsp.2011.04.011
 31. Entezami, A., and Shariatmadar, H., "Damage detection in structural systems by improved sensitivity of modal strain energy and Tikhonov regularization method", *International Journal of Dynamics and Control*, Vol. 2, No. 4, (2014), 509-520. doi: 10.1007/s40435-014-0071-z
 32. Li, H., Yang, H. and Hu, S.L.J., "Modal strain energy decomposition method for damage localization in 3D frame structures", *Journal of Engineering Mechanics*, Vol. 132, N. 9, (2006), 941-951. doi: 10.1061/(ASCE)0733-9399(2006)132:9(941)
 33. Seyedpoor, S.M., and Yazdanpanah, O., "An efficient indicator for structural damage localization using the change of strain energy based on static noisy data", *Applied Mathematical Modelling*, Vol. 38, No. 9-10, (2014), 2661-2672. doi: 10.1016/j.apm.2013.10.072
 34. Cha, Y.J., and Buyukozturk, O., "Structural damage detection using modal strain energy and hybrid multiobjective optimization", *Computer-Aided Civil and Infrastructure Engineering*, Vol. 30, No. 5, (2015), 347-358. doi: 10.1111/mice.12122
 35. Li, Y., Wang, S., Zhang, M. and Zheng, C. "An improved modal strain energy method for damage detection in offshore platform structures", *Journal of Marine Science and Application*, Vol. 15, No. 2, (2016), 182-192. doi: 10.1007/s11804-016-1350-1.
 36. Mirjalili, S., Mirjalili, S.M. and Lewis, A., "Grey wolf optimizer", *Advances in Engineering Software*, Vol. 69, (2014), 46-61. doi: 10.1016/j.advengsoft.2013.12.007
 37. Qais, M.H., Hasanien, H.M. and Alghuwainem, S., "Augmented grey wolf optimizer for grid-connected PMSG-based wind energy conversion systems", *Applied Soft Computing*, Vol. 69, (2018), 504-515. doi: 10.1016/j.asoc.2018.05.006

Persian Abstract

چکیده

برخی از زیرساخت‌های عمرانی بر اساس اهمیت آن‌ها برای سیستم نظارت بر سلامت سازه (SHM) برنامه‌ریزی می‌شوند. شناسایی و تشخیص خودکار آسیب در زمان مناسب یکی از اهداف اصلی است که این سیستم با آن روبرو است. یکی از روش‌های برآورد این هدف، بروزرسانی مدل با استفاده از الگوریتم‌های بهینه‌سازی در سازه‌ها است. این مقاله با به‌کارگیری از ترکیب دو پارامتر به روز شونده ماتریس نرمی و انرژی کرنشی استاتیکی با استفاده از (AGWO) و تنها با استخراج از داده‌های سازه‌ی آسیب دیده به همراه ۵ درصد نویز، به ارزیابی موقعیت و شدت خسارت می‌پردازد. خطای بین نتایج شبیه‌سازی شده و تخمین زده شده در میانگین ده اجرا و هر سناریوی آسیب کمتر از ۳ درصد بوده که عملکرد مناسب این روش را در تشخیص کلیه‌ی آسیب‌های ساختاری قاب سه بعدی ۳۷ عضوی و خرابی دو بعدی ۳۳ عضوی اثبات می‌کند. علاوه بر این، آن‌ها نشان می‌دهند که (AGWO) می‌تواند یک ابزار قابل اعتماد برای شناسایی دقیق آسیب در مقایسه با بهینه‌ساز ازدحام ذرات (PSO) و بهینه‌ساز گرگ خاکستری (GWO) ارائه دهد.
